



**haca.studio**

Krakow  
Venue Presentation





# Index

01

Availability

03

Cocktail Reception

02

Conference & Workshop

04

Summary



# AVAILABILITY

01

# AVAILABILITY – CONFERENCE & WORKSHOP

18th to 20th November and 25 to 27 November

DoubleTree by Hilton

Qubus Hotel

Sheraton Grand Krakow

(Option first come, first serve for all venues)

Tuesday 25th and Wednesday 26th November

ICE Krakow Congress Center

(Option first come, first serve for all venues)

# AVAILABILITY – COCKTAIL RECEPTION

## **Evening 1**

DoubleTree by Hilton

Qubus Hotel

Sheraton Grand Krakow

ICE Krakow Congress Center

(Option first come, first serve for all venues)

## **Evening 2**

Stara Zajezdnia Kraków (Option first come, first serve)

Wieliczka Salt Mine (Option first come, first serve)

(Option first come, first serve for all venues)





# CONFERENCE & WORKSHOP

02





DOUBLE TREE BY HILTON

# VENUE – FLOORPLAN –2ND FLOOR

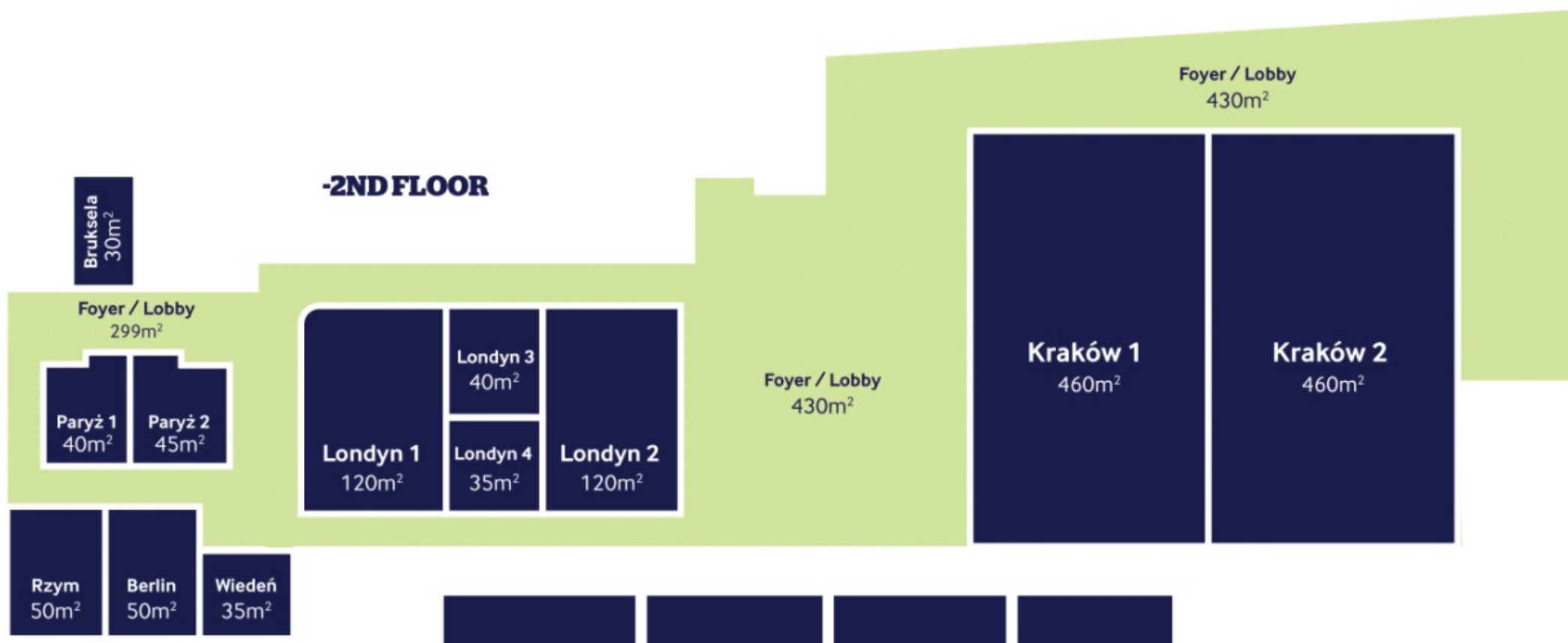



# VENUE – FLOORPLAN GROUND FLOOR



**GROUND FLOOR**

# VENUE – CAPACITY CHART –2ND FLOOR



Name	Size (L x W x H)	Area (m²)	Classroom	Theater	Banquet	Cabaret	Boardroom	U-shape	Hollow square	Cocktail
<b>-2 ND FLOOR</b>										
<b>Kraków (1+2)</b>	<b>28 x 33 x 4,96</b>	<b>920</b>	<b>600</b>	<b>1000</b>	<b>648</b>	<b>432</b>	<b>n/a</b>	<b>115</b>	<b>160</b>	<b>800</b>
Kraków 1	16,45 x 28 x 4,96	460	273	500	288	192	n/a	90	102	400
Kraków 2	16,45 x 28 x 4,96	460	273	500	288	192	n/a	90	102	400
<b>Londyn (1+2+3+4)</b>	<b>11,94 x 26,94 x 2,88</b>	<b>320</b>	<b>n/a</b>	<b>280</b>	<b>204</b>	<b>n/a</b>	<b>n/a</b>	<b>n/a</b>	<b>n/a</b>	<b>250</b>
Londyn 1	10,22 x 11,94 x 2,88	120	60	132	72	48	30	26	38	100
Londyn 2	10,02 x 11,94 x 2,88	120	60	132	72	48	30	26	38	100
<b>Londyn (3+4)</b>	<b>6,26 x 11,94 x 2,88</b>	<b>75</b>	<b>21</b>	<b>48</b>	<b>36</b>	<b>n/a</b>	<b>24</b>	<b>21</b>	<b>24</b>	<b>50</b>
Londyn 3	6,26 x 6,46 x 2,88	40	18	24	n/a	n/a	16	12	18	25
Londyn 4	5,58 x 6,46 x 2,88	35	18	24	n/a	n/a	16	12	18	25
<b>Paryż (1+2)</b>	<b>6,73 x 12,96 x 3,3</b>	<b>85</b>	<b>63</b>	<b>80</b>	<b>50</b>	<b>30</b>	<b>30</b>	<b>45</b>	<b>50</b>	<b>60</b>
Paryż 1	5,9 x 6,73 x 3,3	40	27	30	24	16	14	18	20	30
Paryż 2	6,95 x 6,73 x 3,3	45	27	40	24	16	14	18	26	30
<b>Rzym</b>	<b>6,29 x 7,93 x 3,2</b>	<b>50</b>	<b>27</b>	<b>45</b>	<b>30</b>	<b>18</b>	<b>16</b>	<b>18</b>	<b>21</b>	<b>40</b>
<b>Berlin</b>	<b>6,4 x 7,93 x 3,2</b>	<b>50</b>	<b>27</b>	<b>45</b>	<b>30</b>	<b>18</b>	<b>16</b>	<b>18</b>	<b>21</b>	<b>40</b>
<b>Wiedeń</b>	<b>5,4 x 6,2 x 3,3</b>	<b>35</b>	<b>n/a</b>	<b>n/a</b>	<b>n/a</b>	<b>n/a</b>	<b>12</b>	<b>n/a</b>	<b>n/a</b>	<b>n/a</b>
<b>Bruksela</b>	<b>3,89 x 7,1 x 3,25</b>	<b>30</b>	<b>n/a</b>	<b>n/a</b>	<b>n/a</b>	<b>n/a</b>	<b>12</b>	<b>n/a</b>	<b>n/a</b>	<b>n/a</b>

# VENUE – CAPACITY CHART



Name	Size (L x W x H)	Area (m <sup>2</sup> )	Classroom	Theater	Banquet	Cabaret	Boardroom	U-shape	Hollow square	Cocktail
<b>GROUND FLOOR</b>										
<b>Warszawa (1+2+3+4)</b>	10,99 (12,31) x 29,96 x 2,75 (3)	<b>335</b>	<b>200</b>	<b>300</b>	<b>228</b>	<b>160</b>	<b>n/a</b>	<b>n/a</b>	<b>n/a</b>	<b>250</b>
Warszawa 1	8 x 12,31 x 2,75	100	45	72	48	40	30	30	36	70
Warszawa 2	7,55 x 10,99 x 3	80	45	72	48	40	30	30	36	60
Warszawa 3	7,3 x 10,99 x 3	80	45	72	48	40	30	30	36	60
Warszawa 4	6,75 x 10,99 x 3	75	45	72	48	40	30	30	36	60



# VENUE – ANALYSIS DOUBLETREE BY HILTON



## ○ Pros

- Plenary Room “Kraków 1” (460 m<sup>2</sup>) – perfect for the main plenary room
- Breakout Rooms “Warszawa 1–4” & “Bruksela” – ideal for the workshop sessions
- The Warszawa 1+2+3+4 room, when the walls are folded, can be divided into four separate rooms. More breakouts may be available if needed
- Discounted hotel room rates proposed at the DoubleTree by Hilton (232 rooms) and Hampton by Hilton (161 rooms)
- 10 minutes from Kraków Main Station (PKP), 30 minutes from the airport (KRK) and 5 minutes to Lotników Park

## ○ Cons

- No natural daylight in the plenary room
- Plenary room located in –2nd floor
- Plenary and breakouts are located on two different floors
- Pillars located in the plenary room



# ICE KRAKOW CONGRESS CENTER

# VENUE – FLOORPLAN – HALLWAY – H3



Download



# VENUE – FLOORPLAN S3 CHAMBER HALL

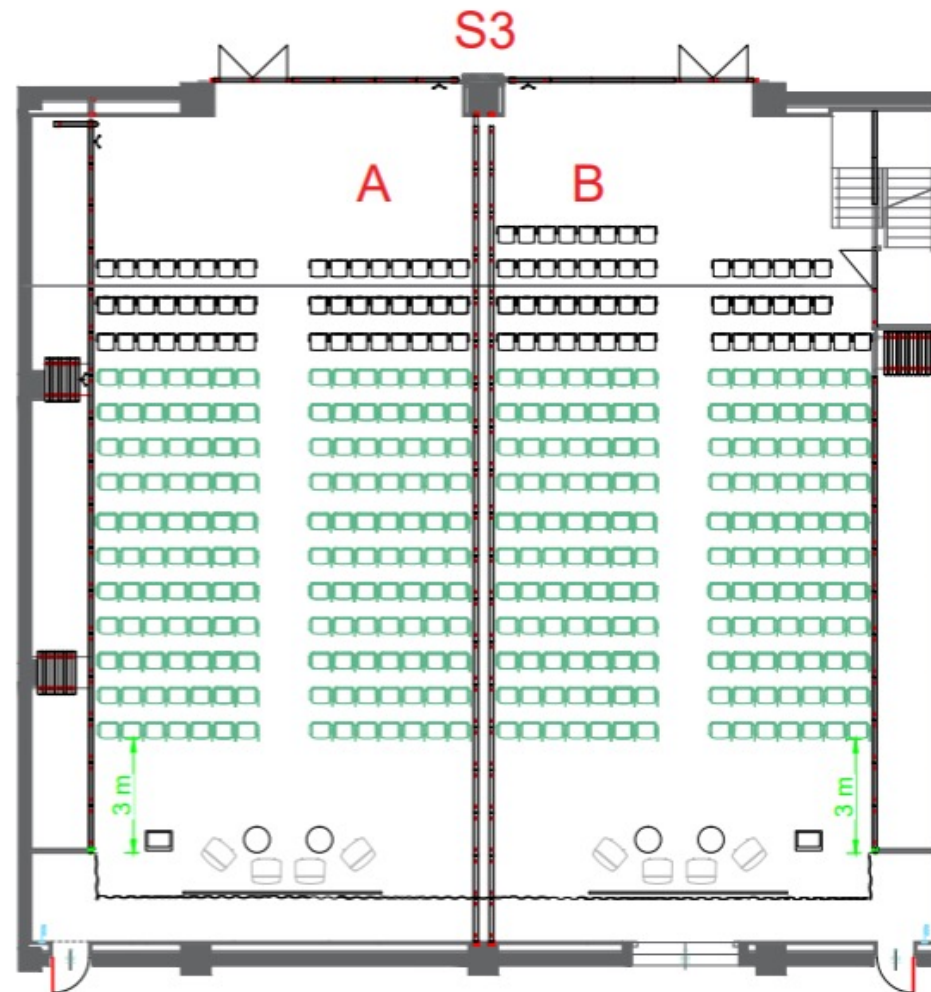

# VENUE – FLOORPLAN – S4 CONFERENCE HALL COMPLEX

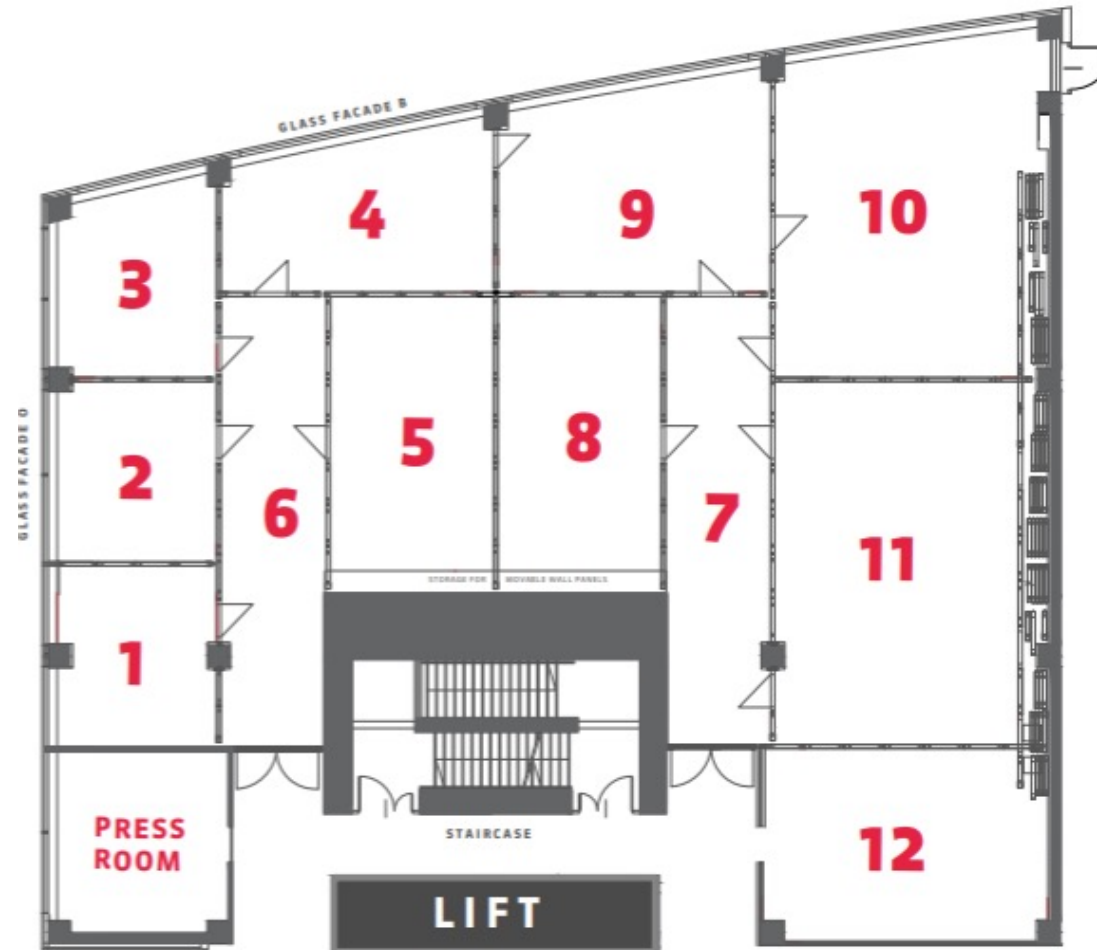

# VENUE – CAPACITY CHART



	Theatre	Boardroom	Gala Dinner	Simultaneous translation	AV Equipment
CHAMBER HALL   S3	400/2×200 pax	60/2×50 pax	180 pax	✓	✓
CONFERENCE HALL COMPLEX   S4	400/11×24 pax	60/11×12 pax	250 pax	—	✓



# VENUE – ANALYSIS ICE KRAKOW CONGRESS CENTER



## ○ Pros

- Plenary Room "S3" (500sqm2) – perfect for the main plenary room
- Breakout Rooms "S4" – ideal for the workshop sessions
- S4 can be split into 10 breakout rooms giving flexibility for your workshops and for the poster sessions
- Natural daylight in the breakout rooms
- S3 and S4 are on the same floor with the networking space in between the two spaces
- Very well located with numerous hotels available in the area

## ○ Cons

- No natural daylight in the plenary room
- Booking spaces are per day in this congress center (07h00 to 23h00) meaning we need to book the entire setup day too but could be a good option to organise the cocktail reception on evening 1 in the networking area



# QUBUS HOTEL

# VENUE – FLOORPLAN

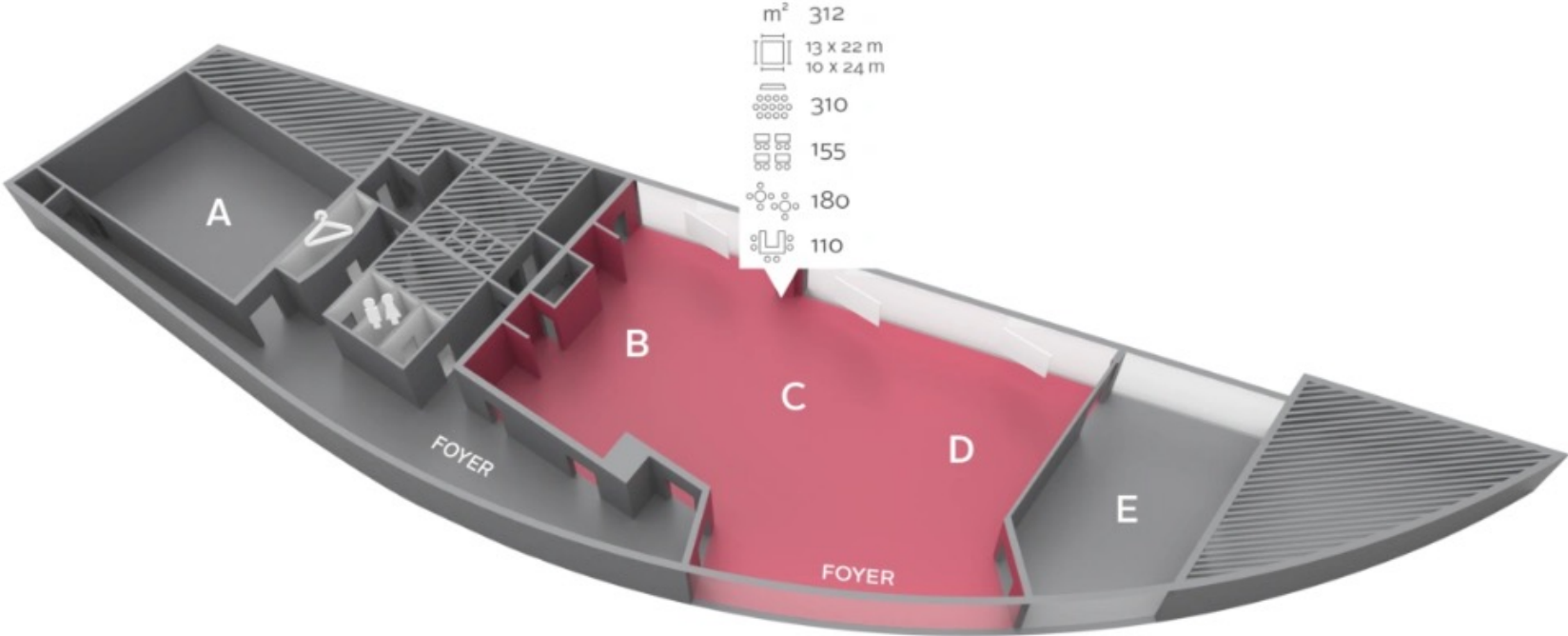



# VENUE – FLOORPLAN

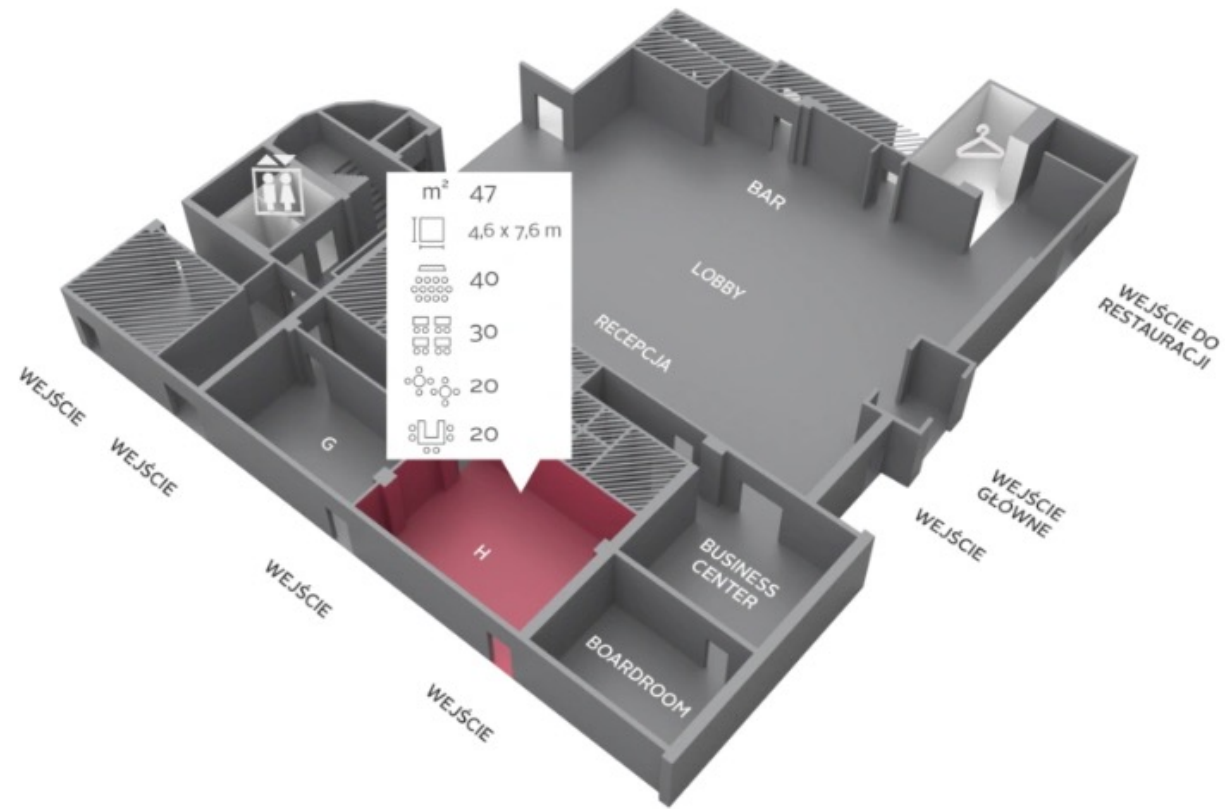

# VENUE – ANALYSIS QUBUS HOTEL



## ○ Pros

- Plenary Room (290sqm2) – Just right for the main plenary room
- 4 breakout rooms – Just right for the workshop sessions
- Natural daylight in the plenary room and breakout rooms
- Hotel rooms will be made available to your guests in this hotel
- Very well located in the city
- Exclusivity of the event spaces for the event possible

## ○ Cons

- Plenary and breakouts are located on two different floors
- Space for networking area / coffee break is small



# SHERATON GRAND KRAKOW

# VENUE – FLOORPLAN – GROUND FLOOR

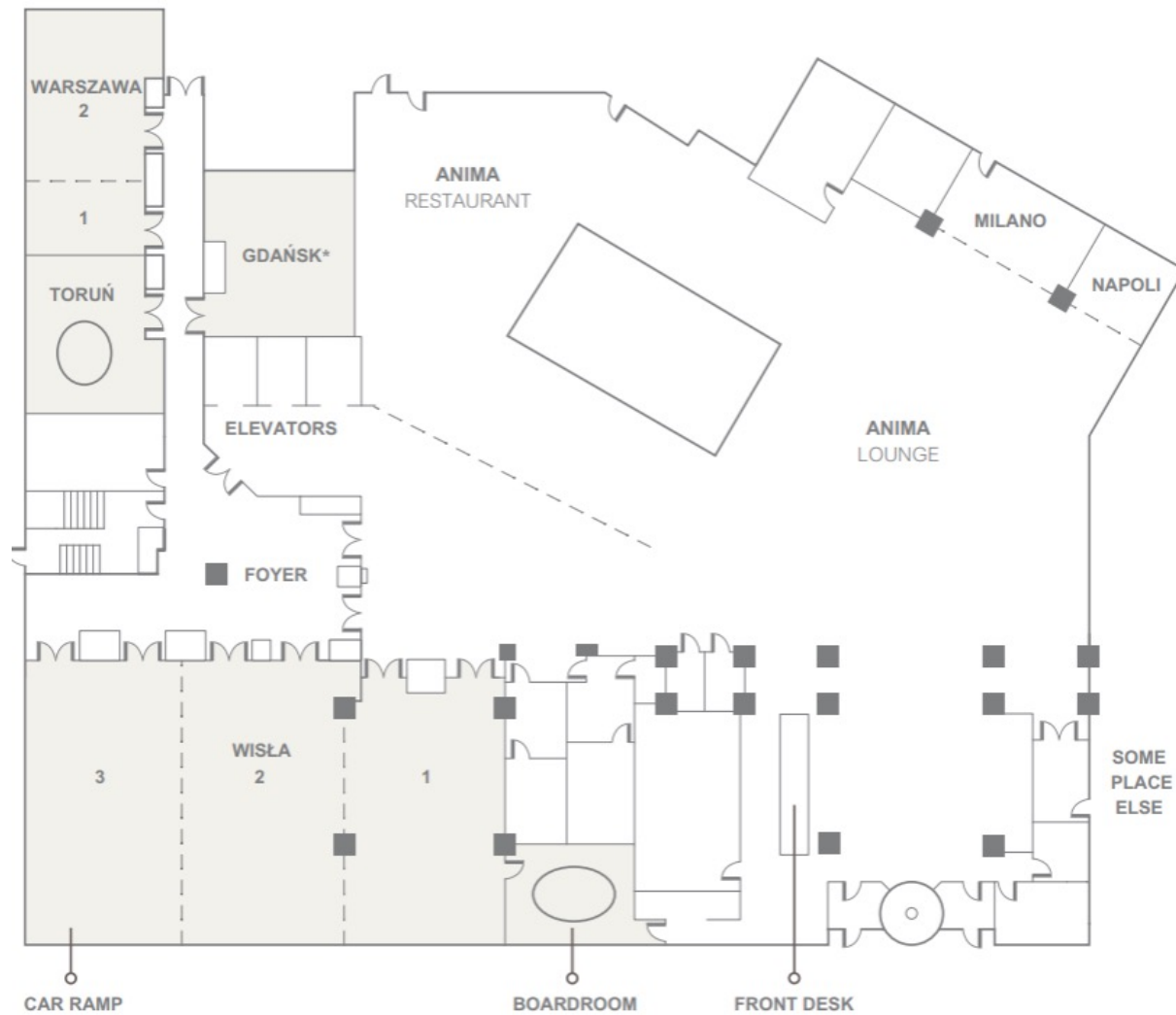



# VENUE – CAPACITY CHART



Meeting Room Sala	Dimensions Rozmiar m*m	Area Powierzchnia m2	Height Wysokość cm	Theatre Teatr	Classroom Szkolne	Boardroom Stół owalny	U-Shape Podkowa	Reception Koktail	Dining Bankiet	Dinner Dance Bankiet z tańcami
Wisła	23*14	310	310	300	140	70	60	300	216	156
Wisła 1+2	15,5*14	205	310	150	75	-	50	190	144	108
Wisła 2+3	15*14	210	310	200	100	60	60	200	144	108
Wisła 1	8*12,5	100	310	70	45	40	40	80	72	48
Wisła 2	7,5*14	105	310	80	45	40	40	80	72	48
Wisła 3	7.5*14	105	310	80	45	40	40	80	72	48
Warszawa	12*5,6	67	310	60	40	30	32	50	60	36
Warszawa 1	4,8*5,6	27	310	20	12	12	12	-	12	-
Warszawa 2	7*5,6	39	310	40	18	18	18	25	30	-
Gdańsk*	7.5*6	46	310	40	20	22	22	35	46	-
Toruń	7,5*5,5	41	310	-	-	12	-	-	-	-
Boardroom	6,5*4,7	31	310	-	-	12	-	-	-	-

\* no natural light

# VENUE – ANALYSIS SHERATON GRAND KRAKOW



## ○ Pros

- Plenary Room “Wisla” (310 m<sup>2</sup>) – Just right for the main plenary room
- 4 breakout rooms available for workshops
- Very well located
- Good option for cocktail reception on evening 1

## ○ Cons

- The breakout rooms are a little too small for your workshops
- A pillar is in the main plenary room which will cause difficulties to setup for 300 people
- The hotel is a very traditional property, no modernity look and does not inspire innovation



# COCKTAIL RECEPTION

03





## STARA ZAJEZDANIA KRAKOW BY DESILVA

---



# VENUE DESCRIPTION



## Why Stara Zajeźdźnia Kraków by DeSilva

Stara Zajeźdźnia is a unique venue located in the heart of Kraków's Old Town, offering a perfect blend of historical charm and modern functionality. The building is listed as a UNESCO heritage site and houses an award-winning brewery, making it a truly special setting for any event.

Its central location ensures easy access to Kraków's main attractions and numerous nearby hotels. Inside, the space combines historic architecture with contemporary solutions in a warm and welcoming atmosphere. The venue is known for its excellent cuisine, enhanced by its own organic Highland cattle farm, which places it at the forefront of quality catering.

With extensive experience hosting a wide range of events, from intimate gatherings and thematic celebrations to international conferences, Stara Zajeźdźnia stands out for its flexibility and attention to detail. The team is renowned for adapting both the menu and event setup to meet specific client needs, offering tailored solutions that ensure every event is both memorable and seamlessly executed.

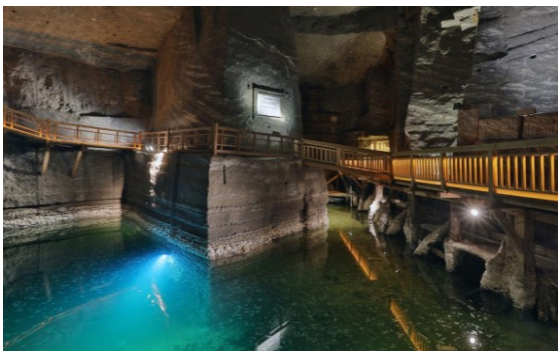

# WIELICZKA SALT MINE

# VENUE DESCRIPTION



## Why Wieliczka Salt Mine

Just a short distance from Kraków, the Wieliczka Salt Mine offers a truly exceptional setting, 125 meters underground, in one of Poland's most iconic landmarks. With a history dating back to the 13th century, the site is a UNESCO World Heritage treasure and a living symbol of craftsmanship and engineering.

The proposed event space, the Warszawa Chamber, is the largest venue of its kind within the mine. With 680 square meters of space, it is perfectly suited for receptions, banquets, and networking events. The chamber is fully equipped with a stage, lighting, sound system, internet access, and catering facilities—making it a versatile choice for impactful gatherings.

Wieliczka Salt Mine is not only known for its stunning underground architecture and sculptures but also for its expertise in event organisation. It has hosted a wide range of prestigious events, including international summits, classical concerts, and cultural galas.

As part of the guest experience, a guided underground tour can be offered to explore the mine's hidden lakes and chapels, including the extraordinary St. Kinga's Chapel. To add a local and festive touch, the mine's historic Representative Brass Band is also available to perform during the event.

Wieliczka Salt Mine combines heritage, atmosphere, and flexibility—offering an unforgettable experience in a one-of-a-kind location.





# SUMMARY



## SUMMARY CONFERENCE & WORKSHOP

DoubleTree by Hilton	ICE Krakow Congress Center	Qubus Hotel	Sheraton Grand Krakow
25 to 27 November 2025	24 to 26 November 2025	18 to 20 November 2025 25 to 27 November 2025	18 to 20 November 2025 25 to 27 November 2025
Hotel rooms available for your guests at the hotel	Hotel rooms available outside the venue	Hotel rooms available for your guests at the hotel	Hotel rooms available for your guests at the hotel
Option first come first serve	Option first come first serve	Option first come first serve	Option first come first serve

# SUMMARY COCKTAIL RECEPTION

ICE Krakow Congress Center	Sheraton Grand Krakow	Stara Zajezdania Krakow	Wieliczka Salt Mine
Evening 1	Evening 1	Evening 2	Evening 2
Located in the city	Located in the city	Located in the old town	Located outside the city
Option first come first serve	Option first come first serve	Option first come first serve	Option first come first serve



**THANK YOU**